

PLAT NO
14394

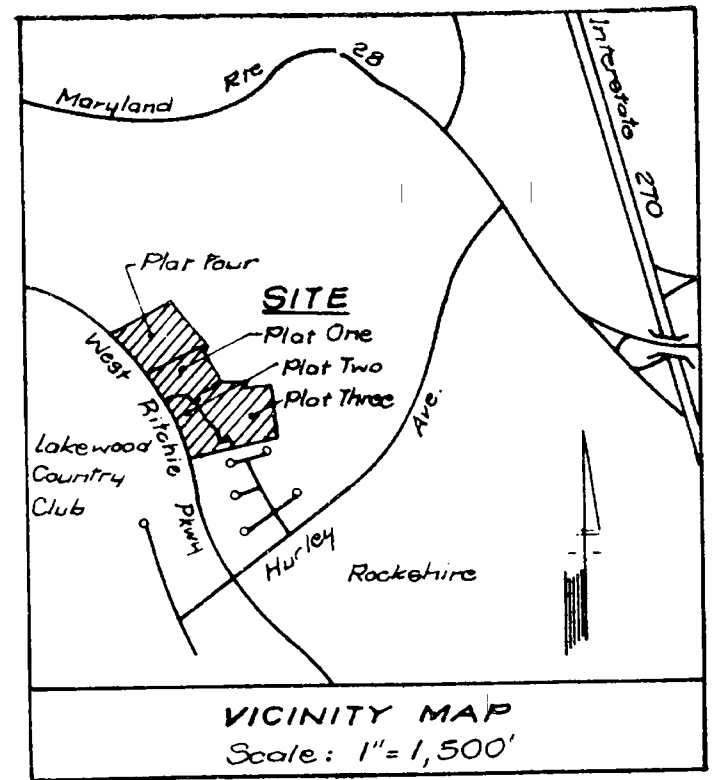

OWNER'S DEDICATION

We, DENNIS ROURKE CORPORATION, owners of the property shown and described hereon hereby adopt this plan of subdivision, establish the minimum building restriction lines. There are no suits of action, leases, liens or trusts on the property included in this plan of subdivision other than those whose parties in interest thereto have below indicated their assent.

DENNIS ROURKE CORPORATION

7/28/83
Date

Dennis J. Rourke
Dennis J. Rourke
President

Attest *Christy E. Rourke*
Christy E. Rourke
Secretary

We assent to this plan of subdivision:
William M. Canby 7/28/83
WILLIAM M. CANBY (TRUSTEE) DATE
Robert L. Burchett 7-27-83
ROBERT L. BURCHETT (TRUSTEE) DATE

SURVEYOR'S CERTIFICATE

I hereby certify that the plan shown hereon is correct; that it is a subdivision of all of the lands conveyed to DENNIS ROURKE CORPORATION by Henry H. Carter, et al by deed dated Aug. 8, 1983 and recorded among the Land Records of Montgomery County Maryland in Liber 6148 at Folio 650

Iron pipes marked thus \circ and monuments marked thus \square are in place as

FILED

AUG 8 1983

PLAT FOUR
FLINT LEDGE ESTATES
CITY OF ROCKVILLE
4th Election District
Montgomery County, Maryland
Scale: 1" = 50'
May, 1982

I.P.D.S. LTD.
The Interprofessional
Planning & Design Studio Ltd.
802 Sligo Avenue
Silver Spring, Md. 20910
585-5676

The total area included in this plan of subdivision is
211,626 square feet or 4.8583 acres.

Recorded: _____
Plot Book: _____
Plot No: _____

Stephen Stephens
STEPHEN STEPHENS, PLS
M.D. Reg. No. 10748

Approved
City of Rockville Planning Commission
Date: FEB. 23, 1983
Without Commitment as to Installation of Sewer,
Water or Streets
Daniel G. Hahn
Chairman (ACTING) City Manager

Parcel "H"
211,626 sq ft or 4.8583 Ac.
To be conveyed to the
City of Rockville for Park

